

www.symphonycomfort.com

The First
AIR COOLER
Manufacturer with
ISO 9001



Users Manual

SUMO JR.

Symphony

AIR COOLER

Trouble shooting

	Trouble	Cause	Remedy
1	Excessive cooling	Air flow control knob on High mode	Reduce the speed to Medium or Low.
2	Less cooling	Water tank is empty	Fill water in the tank.
3	Water leakage	Drain plug is displaced	Ensure that the Drain Plug (at the back of the cooler towards the bottom) is positioned properly.
		Grill lock has disengaged	Relock the grill by tightening the Thumb screw.
		Unit is moved after the tank is filled	Ensure that you move the cooler only when water tank is empty.
		Cooling pad sagging	Change the cooling pads.
4	Fan not working	Air Flow switch is turned OFF	Switch ON the fan by selecting the required speed.
		Mains Switch is OFF.	Switch ON the Mains Switch.
		Loose contact at the socket	Rectify faulty wiring
		Switch or Motor is defective	Call the nearest service provider.
		Shock on cooler	Leakage between phase and earth

General Instructions:

- While filling water, watch the water level indicator given in front of the cooler.
- Do not overfill the tank.
- Do not move the cooler while the tank is full or when the cooler is on.
- If the supply cord is damaged, it must be replaced by the manufacturer or its service agent or a similarly qualified person in order to avoid a hazard.

Maintenance Instructions:

- Empty the water tank by removing the drain plug.
- Open the side panels to dry up the cooling pads.
- Clean the interiors of the cooler with a dry cloth.
- Oil the motor and pump (preferably SAE 40 grade oil) from the oiling points provided to avoid jamming when not in use.
- While using next time follow the general instructions.
- It is advisable to change the cooling pads every year for better performance of the cooler.
- For genuine Symphony spare parts, contact the nearest authorised service provider.

Please get in touch with the nearest authorised Symphony service centre for fixing any cooler problem.

Wiring diagram

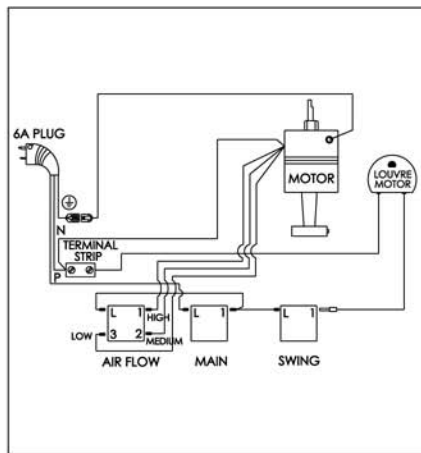

Technical Specifications

Model and Type	- Sumo Jr. / Chhota Sumo
Net Size of body (mm)	- 587 L x 563 B X 655 H
Water Capacity	- 41 ltr.
Rated Current (AMP)	- 1.9 max.
Cooling Area (Approx.)	- 30 sq.m./300 sq.ft.
Nominal Air Capacity	- 1800 m ³ /hr

Electrical Rating

Electrical Rating			
Rated Voltage	Volts	220 - 240	110 - 127
Rated Frequency	Hz	50	60
Motor Speed	RPM	1400	1400
Rated Power (Max.)	Watts	160	175

How to get started

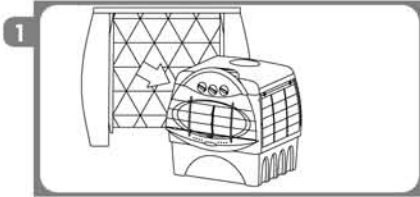

Take the cooler out from the carton and place it in front of an open window. Do not use in a closed room.

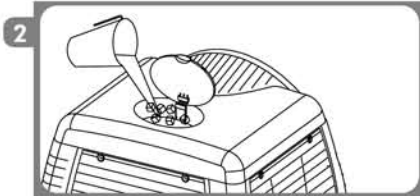

Pour water by lifting the lid on the top. You may also add ice cubes in the Ice chamber for faster cooling, if desired. Check the water level by water level indicator.

Or

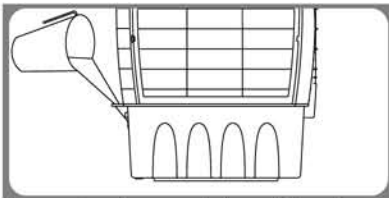

Pour water into the spout at the bottom of the cooler.

Or

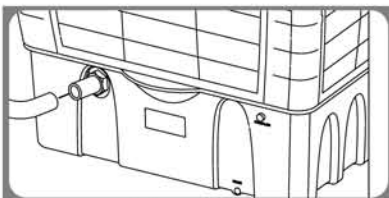

Connect a pipe to the float valve (optional) for continuous supply of water

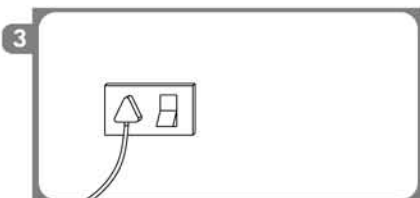

Plug in to 5A power source & switch on.

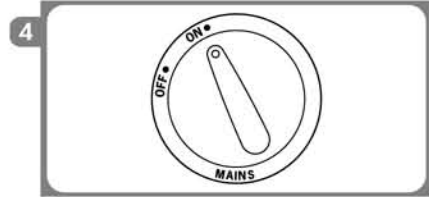

Turn ON the Mains switch.

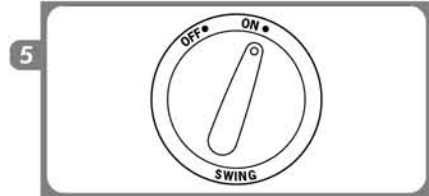

Swing: Vertical swing of air is active.



For maximum cooling turn the Air Flow knob to 'High'.

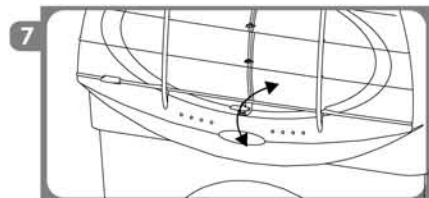

Adjust louver for air movement in horizontal direction.



Sit back and enjoy.

Identification of parts

